



iVolve N2

Nasal Mask (BMC-NM2)



Simple to use, Easy to fit

iVolve N2 nasal mask is innovative, extremely simple and designed for easy fitting. Its lightweight design and small profile make it a perfect mask for patients looking for a lighter and less obtrusive mask. The N2 has quiet venting and very soft silicone cushioning to improve patient comfort.



PRODUCT CODES

Item	Part #
<u>iVolve N2 Nasal Mask (Small Size) with Headgear</u>	10NMS220XX
<u>iVolve N2 Nasal Mask (Medium Size) with Headgear</u>	10NMM220XX
<u>iVolve N2 Nasal Mask (Large Size) with Headgear</u>	10NML220XX
Spare Parts and Accessories	
<u>Headgear with Clips</u>	20NMM210000
<u>Clips (2 pcs)</u>	350150
<u>Forehead Pad</u>	360081
<u>Main Frame (Small)</u>	350211
<u>Main Frame (Medium / Large)</u>	350210
<u>Cushion, Small</u>	360058
<u>Cushion, Medium</u>	360059
<u>Cushion, Large</u>	360060
<u>Elbow and Swivel</u>	350212

Simple structure, easy to disassemble and clean

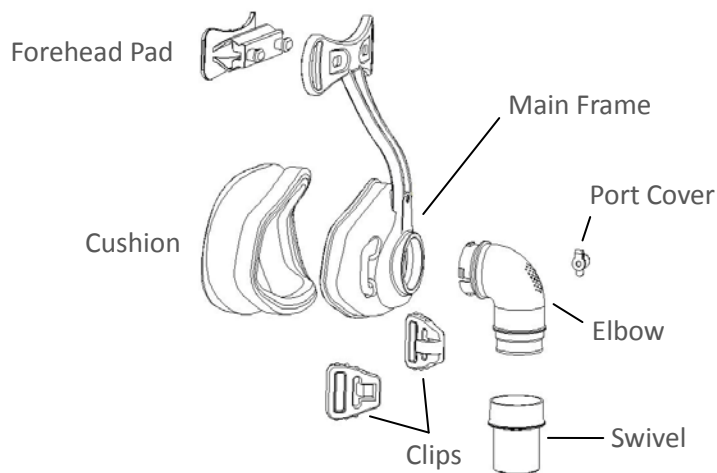
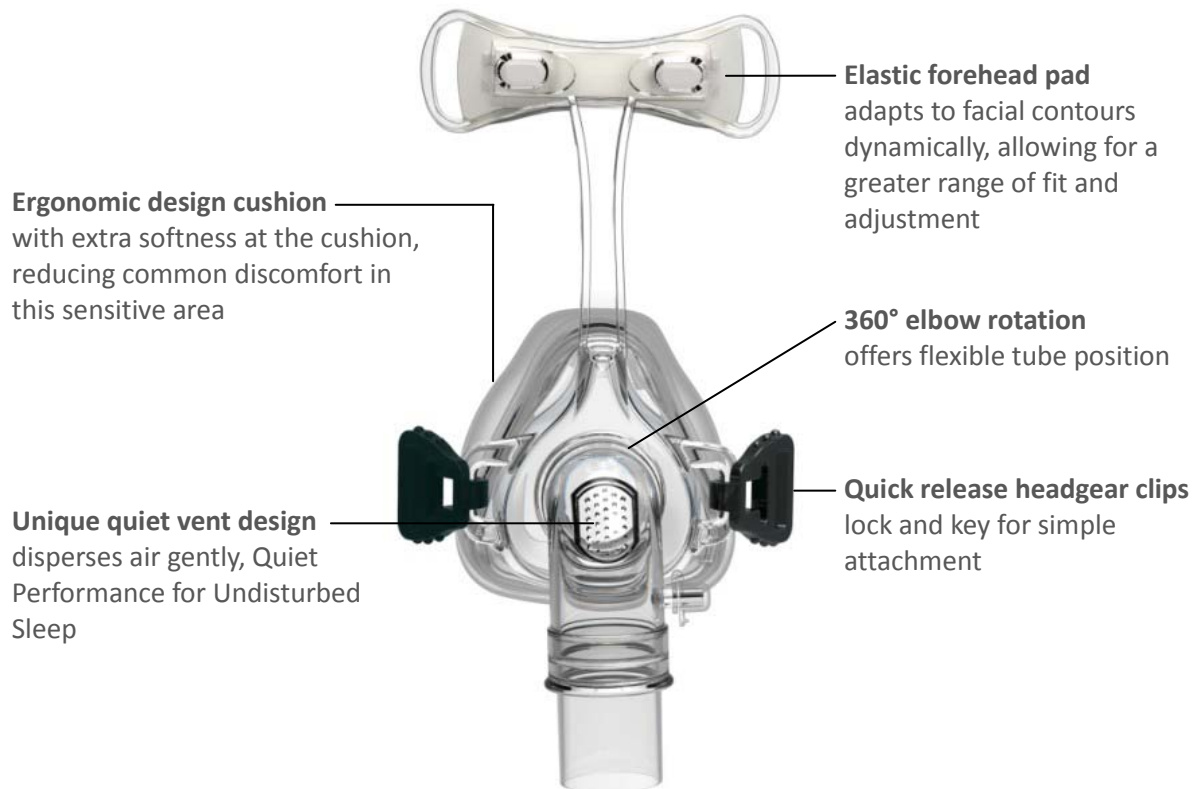

Construction of iVolve N2 Nasal Mask

Manufacturer: BMC Medical Co., Ltd.

NOTE: Specifications subject to change without prior notice.

20140221